

Stirnräder

Geradeverzahnt aus Edelstahl, rostfrei

Eingriffswinkel 20°

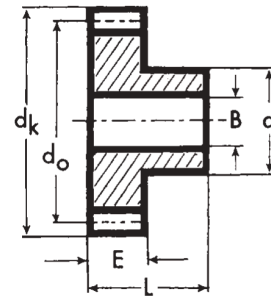

Modul 1,0 bis 2,0

Bestell-Nr.:	Modul	Zähnezahl	B ^{H7}	d	dk	do	L	E	Werkstoff
1012 SS	1,0	12	5	9	14,0	12,0	16	8	1.4305
1015 SS	1,0	15	6	12	17,0	15,0	16	8	1.4305
1018 SS	1,0	18	8	15	20,0	18,0	16	8	1.4305
1020 SS	1,0	20	8	17	22,0	20,0	16	8	1.4305
1025 SS	1,0	25	8	22	27,0	25,0	16	8	1.4305
1030 SS	1,0	30	8	25	32,0	30,0	16	8	1.4305
1035 SS	1,0	35	10	28	37,0	35,0	16	8	1.4305
1040 SS	1,0	40	10	30	42,0	40,0	16	8	1.4305
1050 SS	1,0	50	10	35	52,0	50,0	16	8	1.4305
1060 SS	1,0	60	10	50	62,0	60,0	16	8	1.4305
1512 SS	1,5	12	6	13	21,0	18,0	24	12	1.4305
1515 SS	1,5	15	8	18	25,5	22,5	24	12	1.4305
1518 SS	1,5	18	8	22	30,0	27,0	24	12	1.4305
1520 SS	1,5	20	8	25	33,0	30,0	24	12	1.4305
1525 SS	1,5	25	10	30	40,5	37,5	24	12	1.4305
1530 SS	1,5	30	10	35	48,0	45,0	24	12	1.4305
1535 SS	1,5	35	10	40	55,5	52,5	24	12	1.4305
1540 SS	1,5	40	12	45	63,0	60,0	24	12	1.4305
1550 SS	1,5	50	12	55	78,0	75,0	24	12	1.4305
1560 SS	1,5	60	15	60	93,0	90,0	24	12	1.4305
2012 SS	2,0	12	10	18	28,0	24,0	30	16	1.4305
2015 SS	2,0	15	12	24	34,0	30,0	30	16	1.4305
2018 SS	2,0	18	12	30	40,0	36,0	30	16	1.4305
2020 SS	2,0	20	15	33	44,0	40,0	30	16	1.4305
2025 SS	2,0	25	15	43	54,0	50,0	30	16	1.4305
2030 SS	2,0	30	15	50	64,0	60,0	30	16	1.4305
2035 SS	2,0	35	20	50	74,0	70,0	30	16	1.4305
2040 SS	2,0	40	20	60	84,0	80,0	30	16	1.4305
2050 SS	2,0	50	20	80	104,0	100,0	30	16	1.4305

Stirnräder

Geradeverzahnt aus Edelstahl, rostfrei
Eingriffswinkel 20°

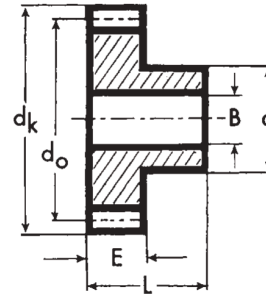

Modul 2,5 bis 4,0

Bestell-Nr.:	Modul	Zähnezahl	B ^{H7}	d	dk	do	L	E	Werkstoff
2512 SS	2,5	12	10	23	35,0	30,0	37	20	1.4305
2515 SS	2,5	15	15	30	42,5	37,5	37	20	1.4305
2518 SS	2,5	18	15	35	50,0	45,0	37	20	1.4305
2520 SS	2,5	20	15	40	55,0	50,0	37	20	1.4305
2525 SS	2,5	25	15	55	67,5	62,5	37	20	1.4305
2530 SS	2,5	30	15	65	80,0	75,0	37	20	1.4305
2535 SS	2,5	35	20	70	92,5	87,5	37	20	1.4305
2540 SS	2,5	40	20	80	105,0	100,0	37	20	1.4305
2550 SS	2,5	50	20	100	130,0	125,0	37	20	1.4305
3012 SS	3,0	12	15	25	42,0	36,0	43	24	1.4305
3015 SS	3,0	15	15	35	51,0	45,0	43	24	1.4305
3018 SS	3,0	18	15	45	60,0	54,0	43	24	1.4305
3020 SS	3,0	20	15	45	66,0	60,0	43	24	1.4305
3025 SS	3,0	25	15	60	81,0	75,0	43	24	1.4305
3030 SS	3,0	30	20	75	96,0	90,0	43	24	1.4305
3040 SS	3,0	40	20	100	126,0	120,0	43	24	1.4305
4012 SS	4,0	12	20	35	56,0	48,0	55	32	1.4305
4015 SS	4,0	15	20	45	68,0	60,0	55	32	1.4305
4018 SS	4,0	18	20	55	80,0	72,0	55	32	1.4305
4020 SS	4,0	20	20	65	88,0	80,0	55	32	1.4305
4025 SS	4,0	25	20	75	108,0	100,0	55	32	1.4305
4030 SS	4,0	30	20	80	128,0	120,0	55	32	1.4305
4040 SS	4,0	40	20	100	168,0	160,0	55	32	1.4305